

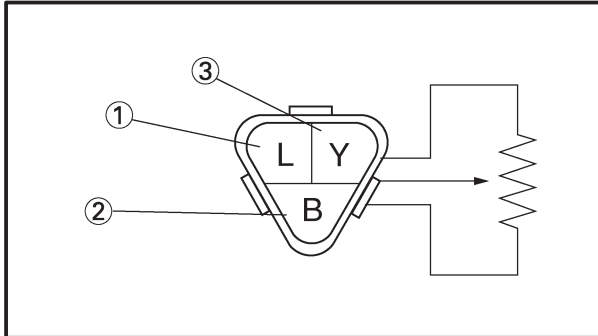

**THROTTLE POSITION SENSOR (T.P.S.)
INSPECTION AND ADJUSTMENT**

NOTE: _____

Before adjusting the throttle position sensor, properly adjust the idle speed.



1. Inspect:

- Throttle position sensor.

Inspection steps:

- Disconnect throttle position sensor coupler.
- Connect the pocket tester ($\Omega \times 1k$) to the throttle position sensor coupler.

Tester (-) lead → Blue terminal ①

Tester (+) lead → Black terminal ②

- Check the throttle position sensor resistance.



**Throttle position sensor
resistance “R₁”:**

**4 ~ 6 k Ω at 20°C (68°F)
(Blue – Black)**

Out of specification → Replace the throttle position sensor.

- Connect the pocket tester ($\Omega \times 1k$) to the throttle position sensor coupler.

Tester (-) lead → Yellow ③

Tester (+) lead → Black ②

- While slowly pushing the throttle check the throttle position sensor resistance.



**Throttle position sensor
resistance “R₂”:**

**0 ~ 4 k Ω at 20°C (68°F)
(Yellow – Black)**

Out of specification → Replace the throttle position sensor.



2. Adjust:

- Throttle position sensor position

Adjustment steps:

- Disconnect the throttle position sensor coupler.
- Connect the test coupler to the throttle position sensor.
- Connect three dry cells (1.5 V × 3 pcs.) in series to the test coupler.

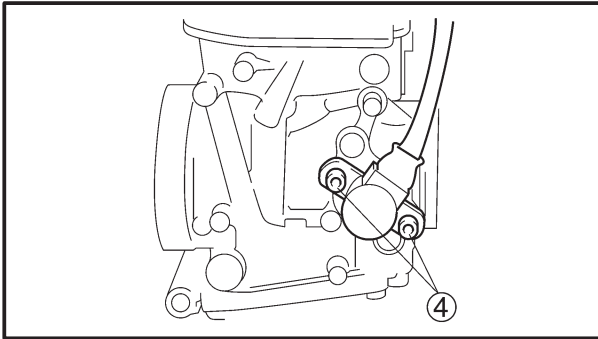
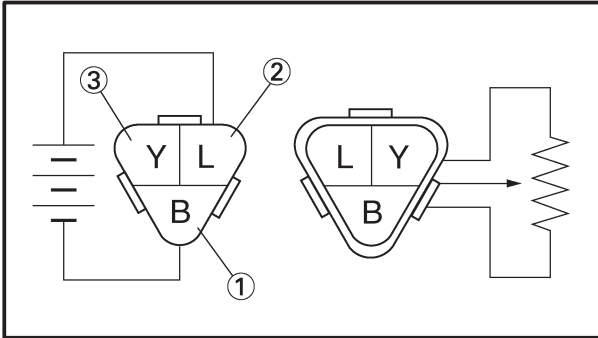

Dry cells (-) → ①

Dry cells (+) → ②

- Connect the digital multimeter to the test coupler.

Digital multimeter (-) lead → ①

Digital multimeter (+) lead → ③

- Measure the voltage (A).

NOTE:

When measuring the voltage (A) be sure that the test coupler is connected to the throttle position sensor.

- Calculate the specified voltage (B).

Specified voltage (B) = Voltage (A) × (0.136)

- Loosen the throttle position sensor bolts (4).
- Connect the digital multimeter to the test coupler

Digital multimeter (-) lead → ①

Digital multimeter (+) lead → ③

- Adjust the throttle position sensor position to obtain the specified voltage (B).
- Tighten the throttle position sensor bolts (4).
- Disconnect the test coupler and connect the throttle position sensor coupler.