



SNOWMOBILE

2/23/2017

S2017-005

TECH EXCHANGE

SUBJECT: 2016~2017 Apex and Vector Models – New Accessory Rear Shock Assembly

©2017 YAMAHA MOTOR CORPORATION, U.S.A.

A new accessory FOX® rear shock assembly has been developed for the Yamaha Single Shot 129" and 146" rear suspensions (see attached Instruction Sheet).

The benefits of the shock are:

- **Larger EVOL® air chamber [1]** - acts as a progressive spring for more comfortable ride and resistance to harsh bottoming.
- **Improved calibration** at lower trail speeds
- **Adjustable rebound and compression damping**
- **Large piggyback reservoir [2]** - reduces fade and maintains more consistent damping in rough conditions
- **User friendly**, easy and quick adjustments for changing conditions

Available for:

Model	Rear Suspension
Apex	Single Shot 129
Apex LE	Single Shot 129
Apex X-TX 1.25	Single Shot 146
Apex X-TX 1.75	Single Shot 146
Apex X-TX LE 1.75	Single Shot 146
RSVector	Single Shot 129
RSVector LE	Single Shot 129
RSVector X-TX 1.25	Single Shot 146
RSVector X-TX 1.75	Single Shot 146
RSVector X-TX LE 1.75	Single Shot 146

NOTE: Does not fit 2015 and earlier models.

(Setting information on the attached Instruction Sheet uses a proper FOX® high pressure air pump up to 300 psi.)

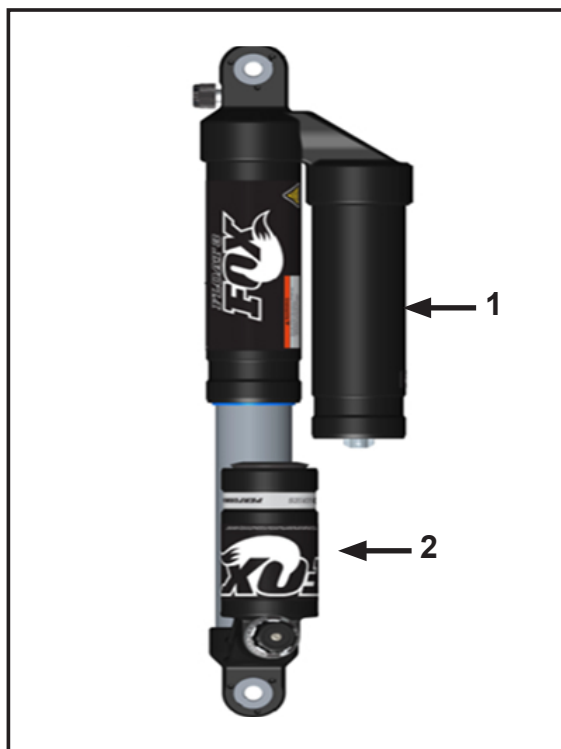

Part Number	Description	Application	Qty.
8LB-47480-00-00	FOX® FLOAT® EVOL® RC Shock Absorber Assembly	2016~2017 Apex and RSVector "Single Shot" Models	1

INSTALLATION INSTRUCTIONS

Description: Accessory FOX® FLOAT®
EVOL® RC
Shock Absorber Assembly
Part Number: 8LB-47480-00-00
Model: 2016~2017 Apex/RSVector

⚠ WARNING

Please read and understand these instructions completely before installation to avoid possible injury, or damage to the accessory or vehicle.



WARRANTY INFORMATION:

In the United States, see your authorized Yamaha dealer for a copy of the *Yamaha Genuine Parts and Accessories Limited Warranty*.

DEALER OR INSTALLER:

These instructions contain important information for future reference and must be given to the customer.

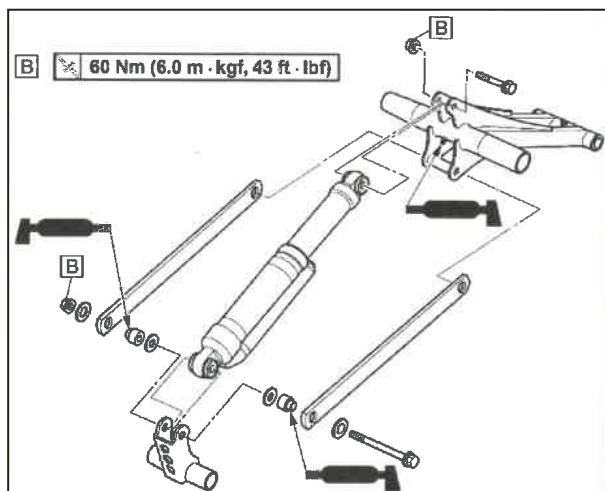
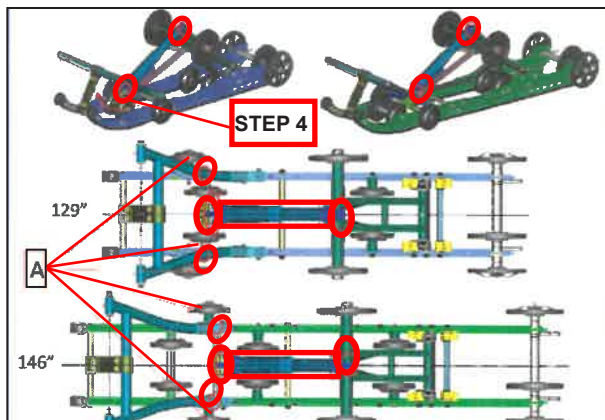

Procedure:

1. Place the snowmobile on a flat and level surface.
2. Unload the rear suspension.
3. Remove front RH and LH idler wheels [A].
4. Swing front pivot forward until the wheels can be spaced out far enough to remove forward shock bolt.

Service Tip:

Top adjacent illustration indicates with red circles all fasteners which need to be removed;

5. Remove both shock bolts [B].
6. Remove original shock (shown in top two illustrations).
7. Place new shock in proper position (shown in bottom picture.)

NOTICE:

Proper shock position: Air tank must be facing down; piggyback tank up and to the right-hand side.

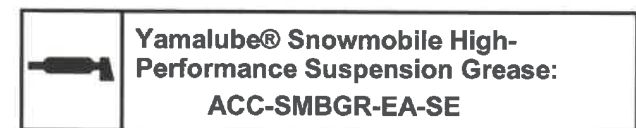

8. Apply snowmobile grease to all pivots (shock grease points shown in adjacent illustration).

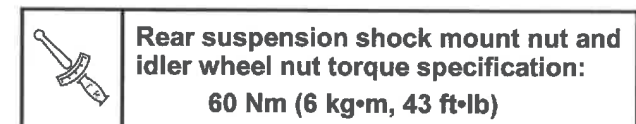

9. Tighten nuts to specification.



10. Confirm that the shock is filled with minimum 200 psi before allowing it to bear any weight (initial setting before proceeding to setting shock sag).

	Initial rear shock pressure setting: Minimum 200 psi
	FOX MEGA FLOAT PUMP: SMA-MEGAF-PU-MP*

* A 300-lb psi pump is provided with the snowmobile at time of delivery. The FOX® MEGA FLOAT® PUMP can be used if the supplied pump is not available.

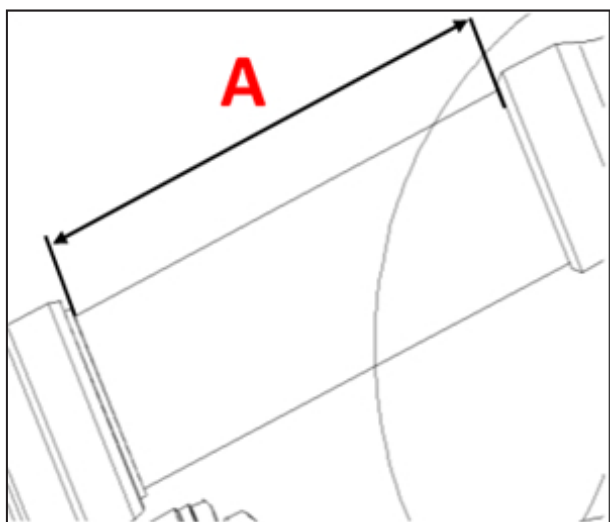

Setting Rear Shock Preload (Sag)

- Lift rear of snowmobile to completely unload the rear suspension
- Adjust the shock air pressure for the rider weight according to the chart shown on page 3.
- Lower the snowmobile and have the customer or someone of similar size sit in a normal riding position with riding gear on.
- Measure distance (A) on the shock tube.
- Correct length of (A) is 120~125mm. Adjust the air pressure in the shock as needed to achieve the correct (A) length.
- Use the FOX® shock air pump provided with the snowmobile or the FOX® MEGA FLOAT® air pump.

Shock Damping Adjuster Settings:

- Turn the compression and rebound damping adjusters in (clockwise) until lightly seated, then turn the adjusters out (counterclockwise) to the #12 position.
- There are 22 available damping adjustment settings.

Compression and Rebound Damping Settings 22 Clicks Total	Standard
Compression	12 clicks counterclockwise from full stop
Rebound	12 clicks counterclockwise from full stop

RECOMMENDED AIR PRESSURE FOR REAR SHOCK ABSORBER 146" TRACK

SingleShot 146		Rider weight with gear (lb)																			
		140	150	160	170	180	190	200	210	220	230	240	250	260	270	280	290	300	310	320	330
Rear shock air pressure PSI	160																				
	170																				
	180	*	*																		
	190	*	*	*	*																
	200	*	*	*	*	*	*														
	210	*	*	*	*	*	*	*	*												
	220	*	*	*	*	*	*	*	*	*	*										
	230			*	*	*	*	*	*	*	*	*	*								
	240					*	*	*	*	*	*	*	*	*	*						
	250							*	*	*	*	*	*	*	*	*	*				
	260									*	*	*	*	*	*	*	*	*	*		
	270										*	*	*	*	*	*	*	*	*	*	*
	280											*	*	*	*	*	*	*	*	*	*
	290												*	*	*	*	*	*	*	*	*
	300													*	*	*	*	*	*	*	*

RECOMMENDED AIR PRESSURE FOR REAR SHOCK ABSORBER 129" TRACK

SingleShot 129		Rider weight with gear (lb)																			
		140	150	160	170	180	190	200	210	220	230	240	250	260	270	280	290	300	310	320	330
Rear shock air pressure PSI	160																				
	170																				
	180																				
	190	*																			
	200	*	*	*																	
	210	*	*	*	*																
	220	*	*	*	*	*	*														
	230	*	*	*	*	*	*	*	*												
	240		*	*	*	*	*	*	*	*	*										
	250				*	*	*	*	*	*	*	*	*								
	260					*	*	*	*	*	*	*	*	*	*						
	270							*	*	*	*	*	*	*	*	*	*				
	280									*	*	*	*	*	*	*	*	*	*		
	290										*	*	*	*	*	*	*	*	*	*	*
	300											*	*	*	*	*	*	*	*	*	*